

QUICK START GUIDE

RB580



This Quick start up guide does not replace in any way or form the user manual of this unit. The intension of this document is for use when setting up the machine after delivery to the dealer and before the machine is transferred to the end user. This document should be used as a checklist and memory aid for employees already familiar with the guidelines in the user manual. Failure to operate the product correctly can result in damage to the product, personal property, and cause serious injury. This guide should not be transferred to the owner of the machine.



QUICK START GUIDE

RB580



After receiving your machine you will want to set it up to be ready for any demo opportunity or sale that may come along. Besides that, you want to be sure that the machine is in factory condition, free of damage from transport and defective parts due to the transport from our factory to your dealership. This is a quick guide that will help you to be up and ready in a short time. Before using the machine you must grease and oil all points on the wrapper that require it.

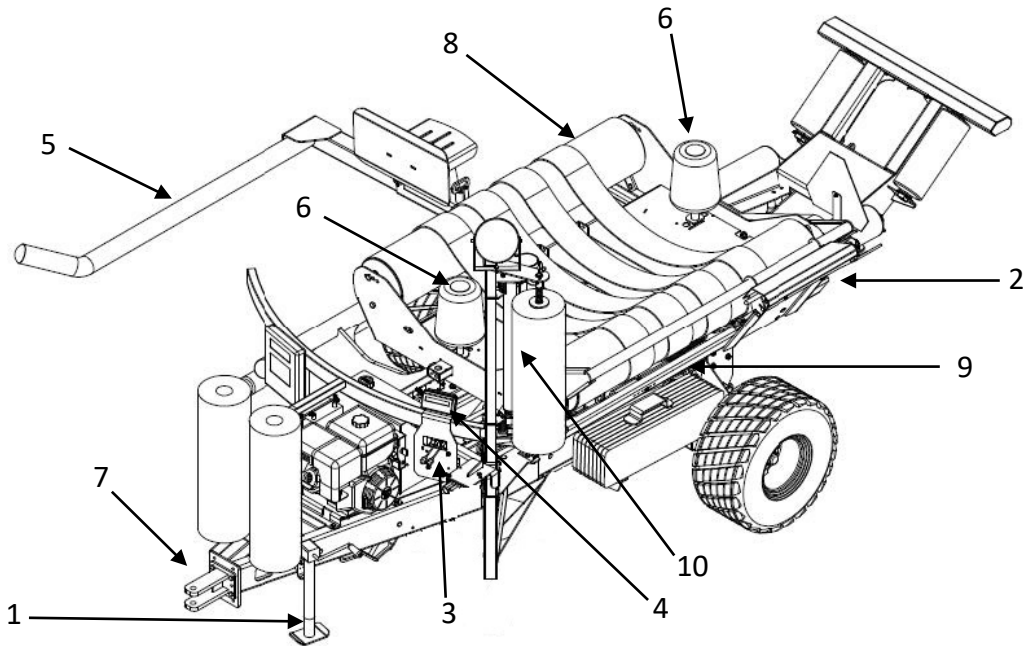

Standard Components	#
Jack with side crank	1
Film cutter	2
Manual controls	3
Computer	4
Loading arm	5
Support roller	6
Tongue	7
Tumtable	8
Tilting table	9
Plastic film stretcher	10

Basics:

Round bale wrapper

- 4 or 5ft bale
- 1 stretcher (30'')
- Bale counter
- Mechanical plastic cut and hold

Note: Before pressure washing the machine be sure to remove the computer (bale counter)

QUICK START GUIDE



RB580

When the machine is to be delivered to the user there are steps you must follow to be sure they are comfortable with wrapping their first bale. These steps are also important if you are doing a live demo. Setup is very important to bale size as this machine is not set to a specific bale at the factory.

- 1) Know your bale size before you start. Asking can help but an actual measurement of the bale is sometimes necessary.
- 2) Be sure that everything is greased (if left for more than 3 months outside without use the machine needs to be fully greased and oiled).
- 3) Your bale counter is charged and tested operational (see user manual on machine for functions).

The stretcher pole has 6 positions. Be sure that the position is not over the height of the bale or under. (this part could have been removed for shipping so be sure to install correctly for wrapping bales)

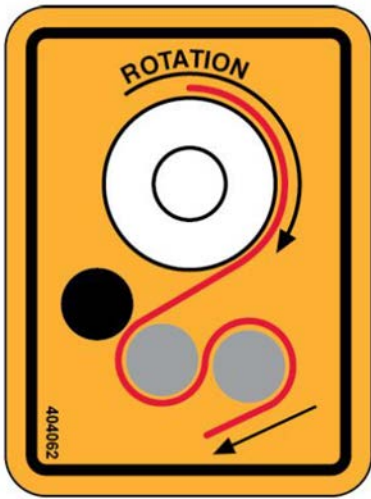

Put plastic in the stretcher. There is only one way to put the plastic through. See the diagram to the left. This is a sticker found on the machine as well.

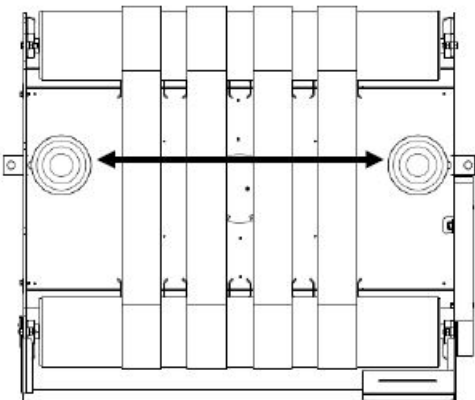

Set the cone roller for 4 or 5 foot long bale.

QUICK START GUIDE

RB580



Hook the machine to a tractor to test it.

Attach the machine hoses to the tractor as shown. Be sure that your tractor is adjusted at a flow rate of 8 GPM at 2000 PSI.



Turn on the bale counter and set.

- 1) Press the on button
- 2) You will have to set the counter. To do so you will hold the Adjust Select for 3 seconds. You can then scroll through 4 menus with the same button (adjust select)
- 3) Use the + and – to change the values of the menu.
- 4) When wrapping you will hear a buzzer from the counter on the last turn so that you know when to stop turning the table. The number will automatically reset once the sequence is finished.



Quick reference for correct plastic layers:

The way that we calculate the amount of plastic to apply on a bale is simple. You wrap the bale manually one time with only one layer of plastic. You do not want to see any part of the bale when you are finished. You take the number of turns of the table that it took you to do this and multiply by 2 and add one extra layer (or turn).

EX: 10 turns to completely cover the bale x 2 = 20. plus one layer = 21. This is the number you want to program in your bale counter.

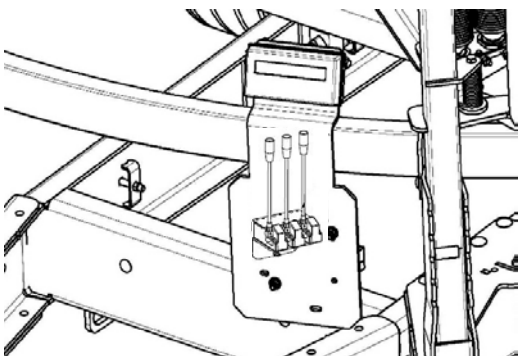

Once the bale counter is setup you can start wrapping with the manual lever. The manual lever can be installed in the tractor with the extension cable, so you can operate from the tractor.

QUICK START GUIDE

RB580



The RB580 is equipped with a mechanical cut and hold system. The mechanical cut and hold works on a rack and pinion system that stretches a large spring as the table turns. The trigger for the release of the system is under the table and is activated as the table dumps. If the plastic don't cut or not completely you want to make sure the blade is sharp and free of rust first. Then you can check if the trigger hit the plate at the right time and adjust it if need be.



Fine tuning adjustment

Activation plate

Basic adjustment

Activated too early



Activated at the right time



QUICK START GUIDE

RB580



The RB580 is equipped with a loading arm that make it possible to load bale directly onto the bale wrapper without using a frontal loader. The loading arm is sent with extension cables to control the wrapper from the tractor seat. For loading a bale, the turntable must be parallel to the loading arm. The loading arm is equipped with a safety device (1) to prevent collisions with the turntable and error operations. The loading arm must be dropped halfway between the turntable and the ground so that the table can rotate. Another safety device (2) is installed to insure that the tilting table is down to be able to lift the arm.

The fork of the arm adjusts to different bale diameter. An adjustable backstop (3) allows you to charge bales of 4 or 5 feet wide and filed on the center of the turntable. When in transport mode you have a safety pin (4) to lock the arm up.

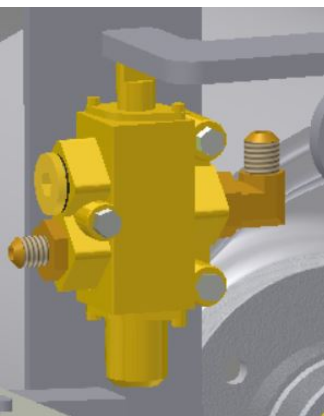

← 1- Tilting table safety

2- Loading arm safety →

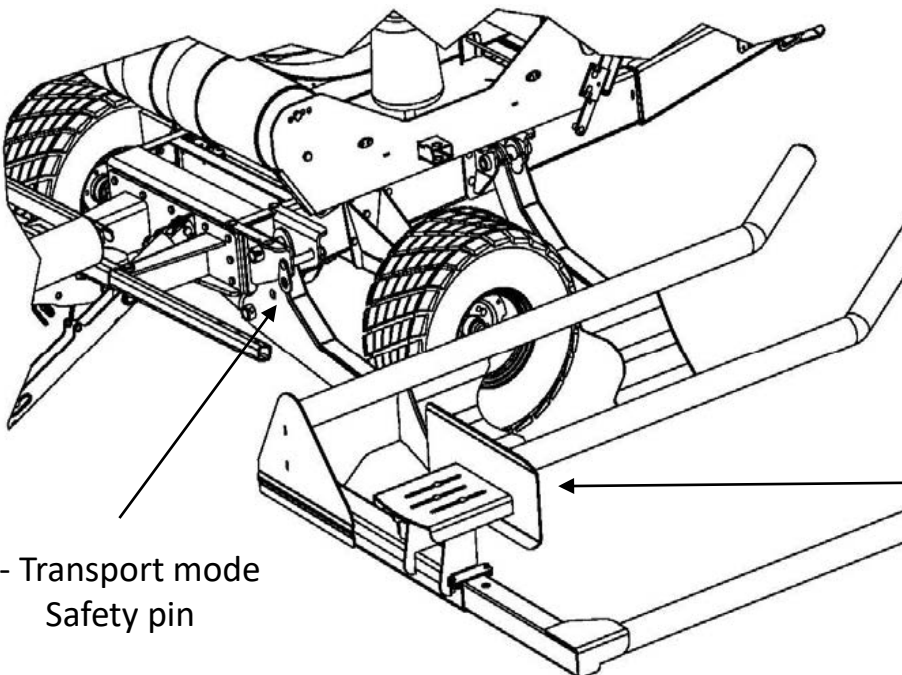
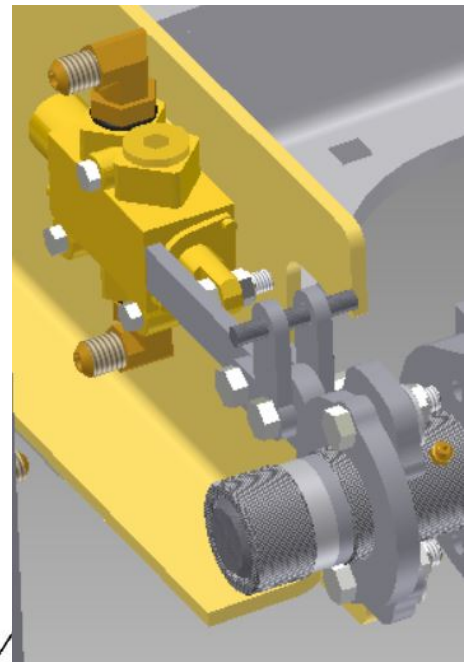

4- Transport mode
Safety pin

3- Bale adjustment