

# QUICK START GUIDE

## 680HS



This Quick start up guide does not replace in any way or form the user manual of this unit. The intension of this document is for use when setting up the machine after delivery to the dealer and before the machine is transferred to the end user. This document should be used as a checklist and memory aid for employees already familiar with the guidelines in the user manual. Failure to operate the product correctly can result in damage to the product, personal property, and cause serious injury. This guide should not be transferred to the owner of the machine.



# QUICK START GUIDE

## 680HS



After receiving your machine you will want to set it up to be ready for any demo opportunity or sale that may come along. Besides that, you want to be sure that the machine is in factory condition, free of damage from transport and defective parts due to the transport from our factory to your dealership. This is a quick guide that will help you to be up and ready in a short time. Before using the machine you must grease and oil all points on the wrapper that require it.

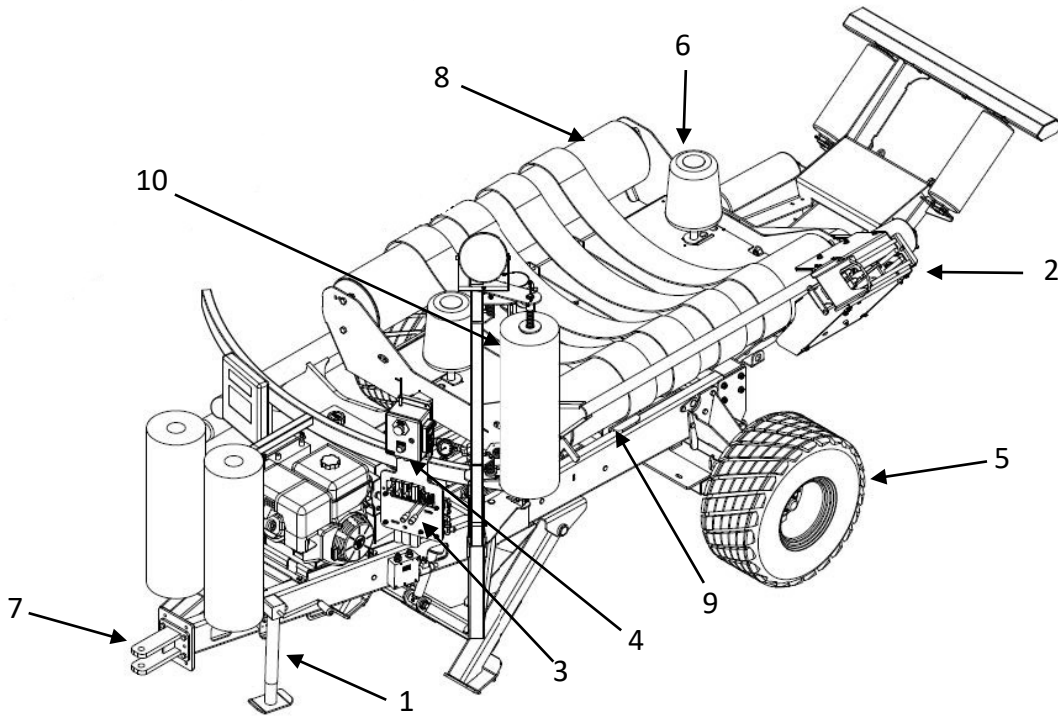

Components	#
Jack with side crank	1
Film cutter	2
Manual controls	3
Computer	4
26 x 12 x 12 Tires (8 plies)	5
Roller support	6
Tongue	7
Turntable	8
Tilting table	9
Plastic film stretcher	10

### Basics:

#### Round bale wrapper

- Up to 6ft bale
- 1 stretcher (30")
- Computer & remote
- Hydraulic plastic cut and hold

Note: Before pressure washing the machine be sure to remove the computer

# QUICK START GUIDE



## 680HS

When the machine is to be delivered to the user there are steps you must follow to be sure they are comfortable with wrapping their first bale. These steps are also important if you are doing a live demo. Setup is very important to bale size as this machine is not set to a specific bale at the factory.

- 1) Know your bale size before you start. Asking can help but an actual measurement of the bale is sometimes necessary.
- 2) Be sure that everything is greased (if left for more than 3 months outside without use the machine needs to be fully greased and oiled).
- 3) Your remote control is charged and tested operational (see user manual on machine for functions).

The stretcher pole has 3 positions. Be sure that the position is not over the height of the bale or under it. (This part is normally removed for shipping so be sure to install it correctly to wrap your bales)

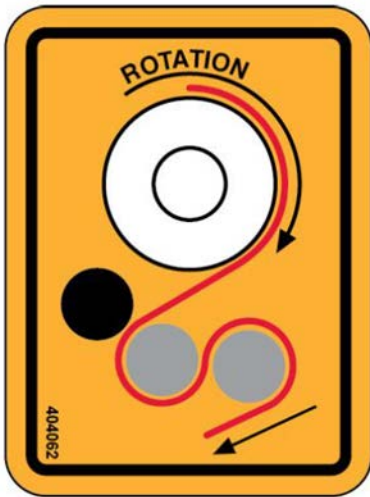

Put plastic in the stretcher. There is only one way to put the plastic through. See the diagram to the left. This is a sticker found on the machine as well.

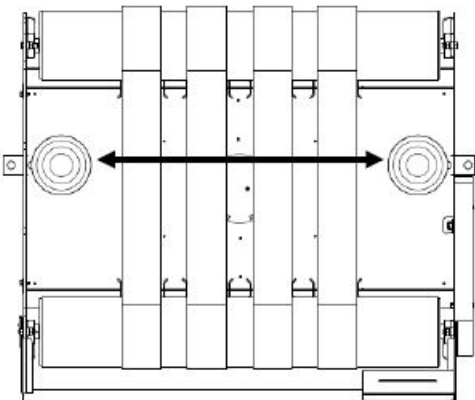

Set the cone rollers for the size of your bales.

# QUICK START GUIDE

## 680HS



### Honda engine

The 680HS is powered by an Honda engine. Before starting the machine make sure it has gas and oil in it. Also when traveling or not using the machine for a long period of time don't forget to close the fuel valve, located beneath the choke on the right side of the engine.



### Turn on the computer.

- 1) Pull the emergency stop button (1), the blue light (2) will come on.
- 2) Press the power button on the remote (3), when the screen is ON push the power button (3) again
- 3) Make sure the M.C. LED light (4) on the receiver's control panel is ON.

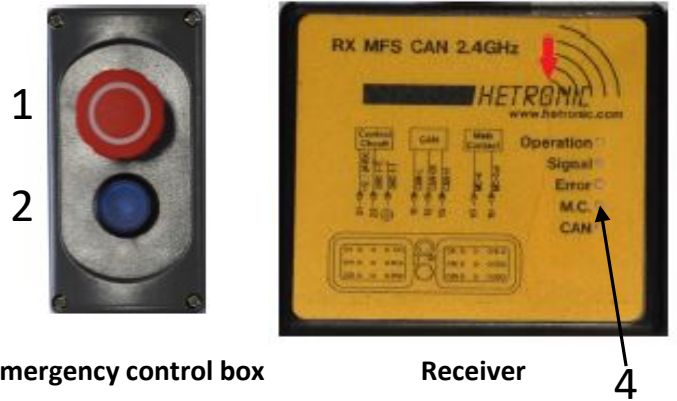

Emergency control box

Receiver

### Starting and Aligning the wrapper.

- 1) If equipped with an Honda engine, put the ignition key in the ON position and press the start engine button on the remote.
- 2) Before wrapping you need to align the wrapper, press the alignment key (5) on the remote control.
- 3) When the alignment menu appears on the remote control screen, press the same key (5) a second time, the alignment will start and the screen should display **Alignment in progress** (it can take up to 2 minutes).

### Start Wrapping

- 1) Make sure the blue button's light (2) is on, which means that the alignment is finished.
- 2) Push the wrap key (6), the wrapper's table will make the set number of rotation and unloading will happen automatically, and will engage the plastic cutter.
- 3) If the remote is not charged or missing you can wrap automatically by pressing the blue button (2).



Remote



# QUICK START GUIDE

## 680HS



The 680HS is equipped with an hydraulic cut and hold system. The hydraulic cut and hold works with the pressure of the main valve and an accumulator.

If the plastic isn't cut or not completely cut you want to make sure the blade is sharp and free of rust first. If the rubber bumper doesn't hold the plastic you can put more tension on the fingers and rubber bumper by adjusting the bolt (1) and the spring with the adjustment rod (2).

