

Miter gear installation

If you have to replace the miter gears of the wrapper follow the below instructions. If you are replacing because of teeth that have broken you must first be sure that you clean the hub of any metal filings or broken teeth of the miter gears. This is a very important component of the machine. Be very careful to follow these instructions.

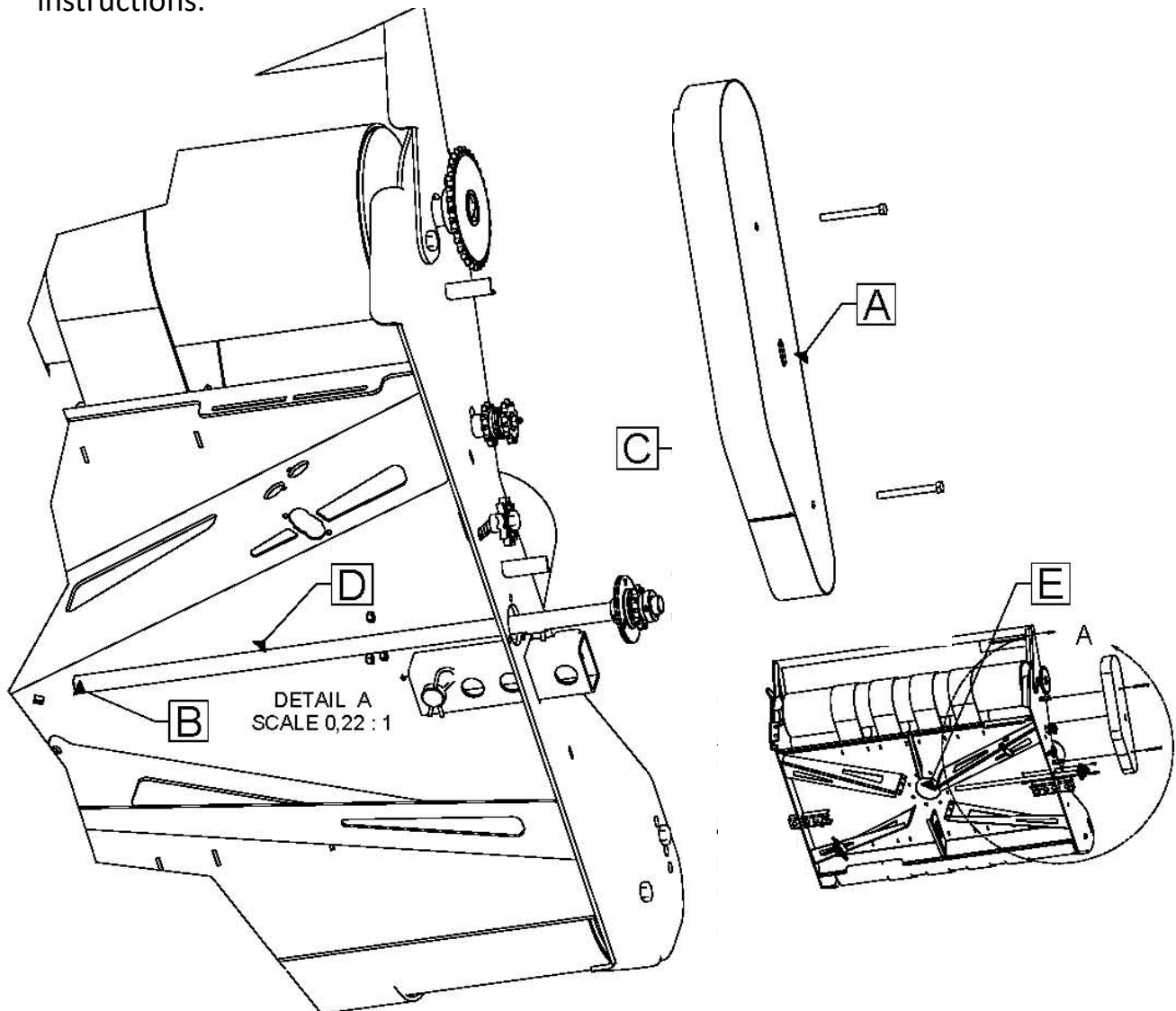

1. Remove the cap in the middle of the table (E).
2. Remove the guard (A).
3. Unscrew the set screw on the mitter gear.
4. Remove the bolt on the flange bearing.
5. Slide the axle out (D).

PROCEDURE REF# A-IND-030



Miter gear installation

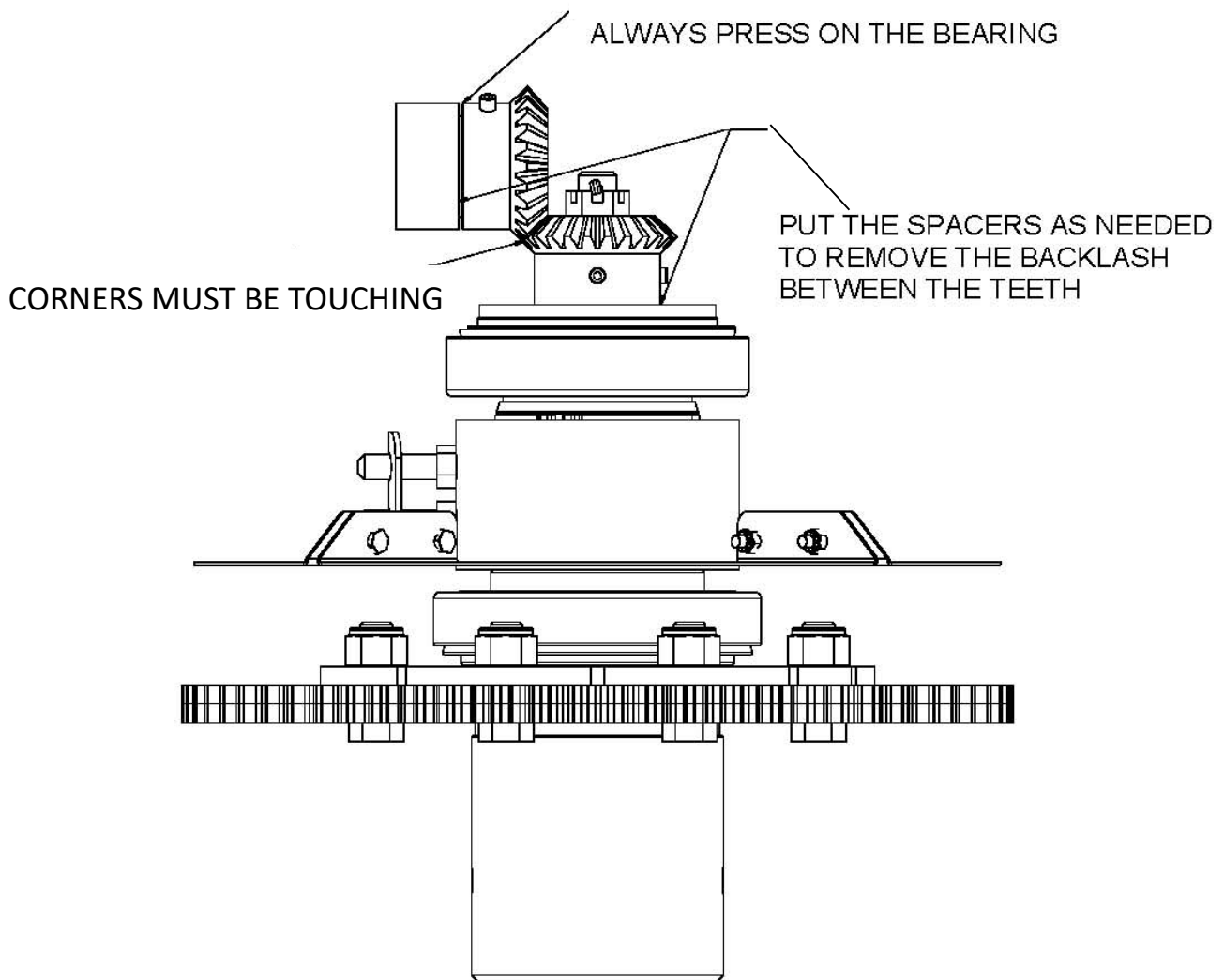

PROCEDURE REF# A-IND-030



Miter gear installation

When installing the castle nut back:

-Torque at 60 pounds

