

## Error #35

If error #35 occurs repeatedly, make sure that the sensor **RPM\_PTO** and the sensor **HYD\_PRESS** are working well before to continue the operations.

Verify the RPM\_PTO first by following the next steps:

1. Stop the tractor's PTO and wait until it is completely stopped.
2. Inspect/adjust the sensor located on the PTO guard. Refer to the protocol A-MER-008 in order to validate the good functioning.
3. If needed, follow the sensor wires from one end to the other to make sure there is no cut or jammed spot.

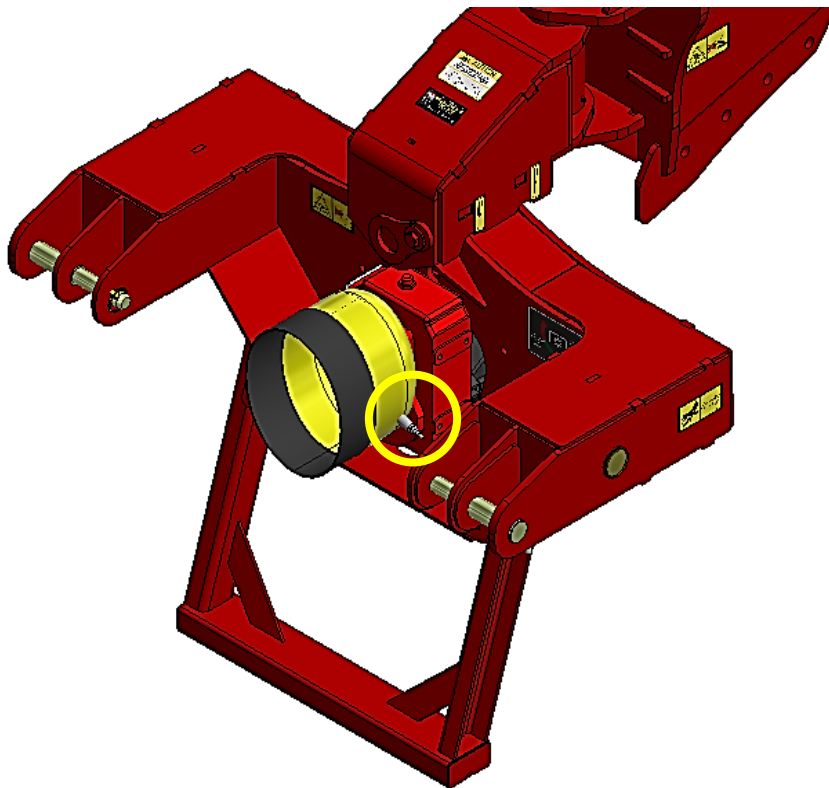

### Error #35

Then, you must take care of the sensor HYD\_PRES by proceeding as follow:

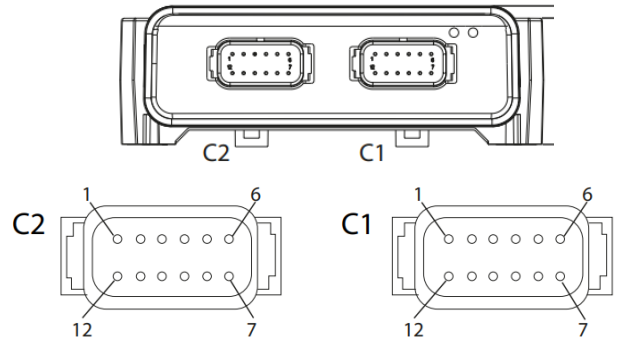
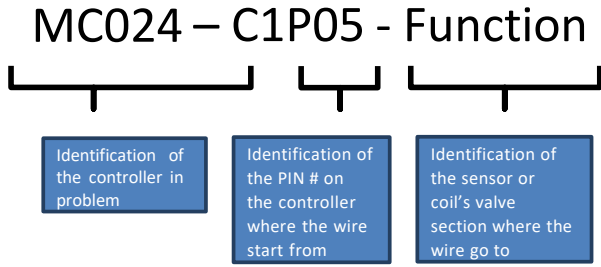

Inspect the wire from pin #05 of the MC024 controller's C1 connector until the hydraulic pressure sensor located as below illustration. If the wire is not damaged, the hydraulic pressure sensor must be replaced. In the Settings menu, click on tab INPUTS/OUTPUTS and the C1-P05 (System pressure) will indicate 0 mV when in error.

