

PROBLEM WITH THE MIX

1 - Be sure to incorporate the ingredients in the following order:

- 1- Dry hay, straw, silage
- 2- Dry grain
- 3- Proteins, premix, additives
- 4- Corn silage
- 5- Liquids

Mix between 3 to 5 minutes, depending on the size of the mixture, after the incorporation of the last ingredients.

2 – Auger are well synchronized (double or triple auger)

- 1- Make sure that the auger are well synchronized (Refer to procedure A-MIX-007)

3 – Position and maintenance of the knives

- 1- Make sure that the position of the knives is correct (Refer to procedure A-MIX-003)
- 2- When the teeth begin to fade, swap the lower knives with the upper ones (#1 with #10, #2 with #9, #3 with #8, #4 with #7, #5 with #6).
- 3- When the teeth are worn on all knives, grind the teeth to a sharp edge.
- 4- When the tungsten coating under the knives begins to wear off, flip all the knives over to have the tungsten coating on top.
- 5- Replace all knives when the cut is no longer satisfactory

Swapping knives

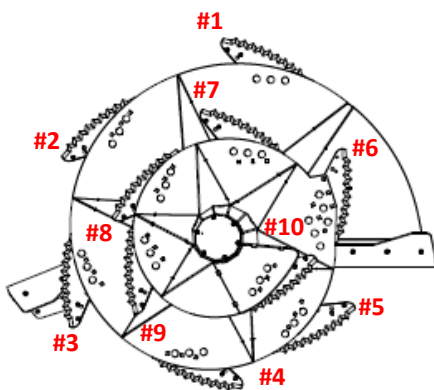

Sharpen the knives

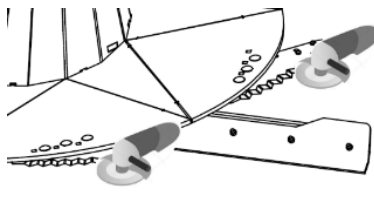

Flat side with reverse tungsten lining

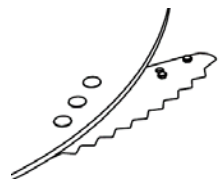

PROBLEM WITH THE MIX

Problem with incorporating ingredients that remain on top

- All RTM vertical mixers on the market operate at their best between 50% and 90% of their base cubic capacity.
- If the level reaches the edge of the side wall of the tank (disregarding the capacity extension), you are using the mixer at 100% capacity and the auger will not be high enough.
- The capacity extension is mainly there to prevent the spillage of the mixture (retention area)
- However Anderson is the only manufacturer to offer an auger extension which can be bolted onto the current auger to enhance your mixer. Ask your dealer about it.
- Each auger extension adds 14 inches to your current auger.
- Highly recommended with any RTM vertical mixer equipped with a capacity extension greater than 12 inches.

Or you will have to prepare a smaller ration depending on the capacity of your mixer, otherwise your mixer must be larger and we will be happy to advise you in this direction.

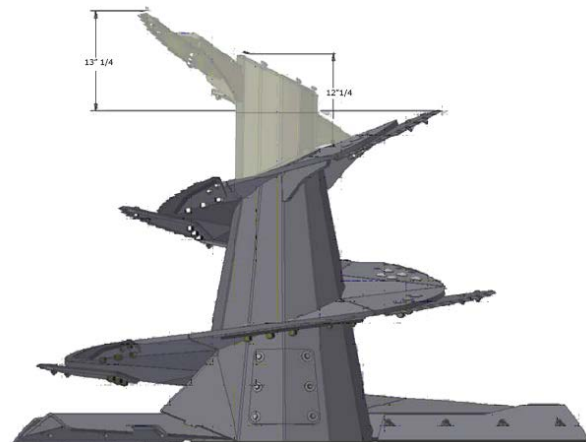
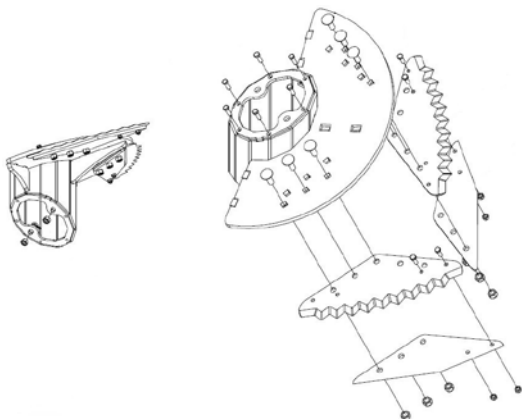

PROBLEM WITH THE MIX

Problem with balls getting stuck between the auger, creating a wall that blocks movement from front to back.

When you drop the bale into the mixer, gently drop it onto the outer part of the mixer above the auger so that it starts to grind before it gets to the center

When you drop the bale, drop the bale with the center towards the outer wall of the tank and not towards the bottom

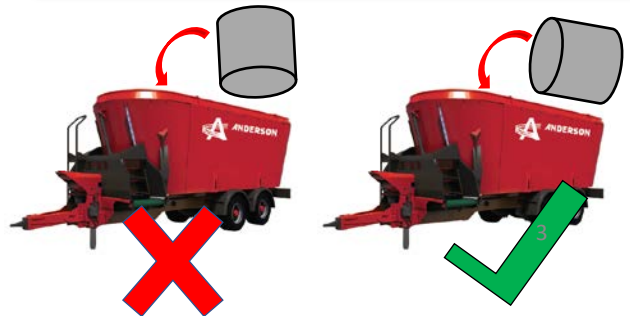
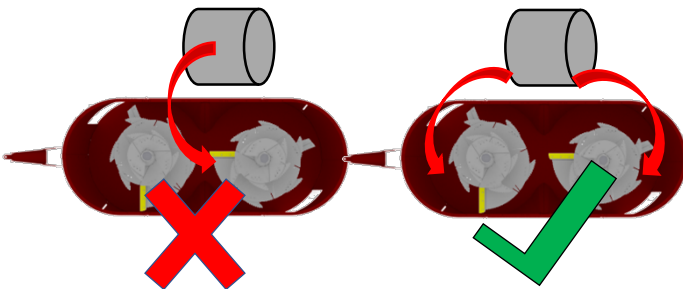

If after using the tips above you still have the same problem, you can contact your Anderson dealership to order offset knife holders, which reduce the “dead zone” between the screws and prevent a wall from forming.

Standard

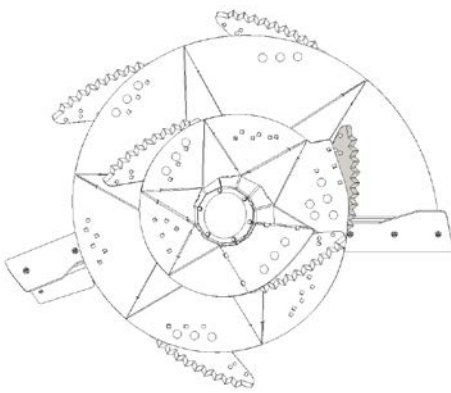

With offset knives

